



# Manhole Products

**60" Type 1 Precast Manhole  
WSDOT B-15.20-01**

### Grade Adjustment Rings Available

- 2", 3", 4", 6"

### Hole or Knock Out Dimensions

- Maximum hole size is 48 inches
- 8 inches of minimum distance between holes
- 2 inch diameter lifting holes provided
- Cored, cast-in and custom block-out/knock-outs available

### Conformity Standards

- ASTM C478 manhole
- ASTM C443 rubber gasket joint
- ASTM D4101 polypropylene steps and ladders
- Washington State APWA / WSDOT Standard

### Options Available

- Pre-channeled base
- Specialized coatings
- Predl systems monolithic GU lined base
- Kor-N-Seal boots
- 1' thru 10' Polypropylene ladders

### Section Specifications

Height	Section	Base
12"	1,240 LBS	2,240 LBS
24"	2,507 LBS	3,507 LBS
36"	3,773 LBS	4,773 LBS
48"	5,040 LBS	6,040 LBS
60"	6,306 LBS	7,306 LBS
72"	7,573 LBS	8,573 LBS

Base Slab	Cone
2,622 LBS	3' 3,237 LBS

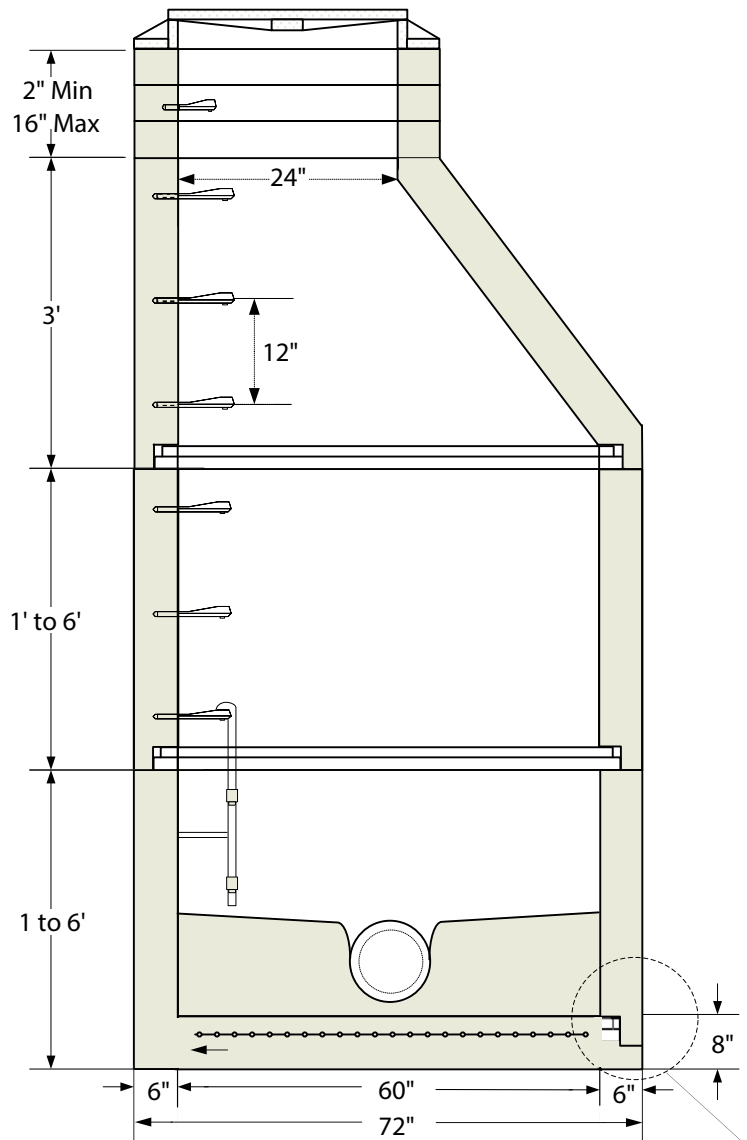

**Top Cone Plan View Gasket Shown Uncompressed**

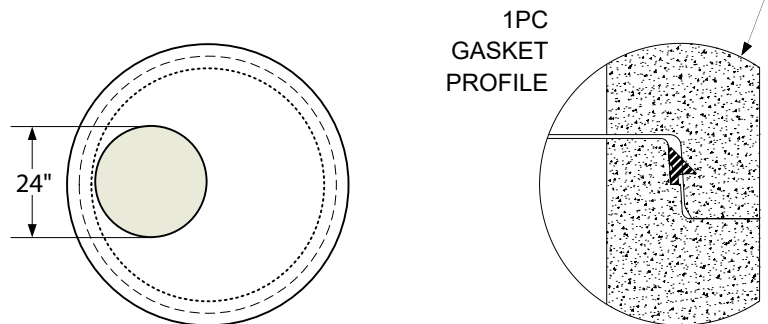

Note: drawings not to scale



Shope Concrete, LLC  
1618 East Main Avenue  
Puyallup, WA 98372-3142

(253) 848-1551  
Fax Line 1 (253) 845-0292  
Fax Line 2 (253) 864-6172

1-800-422-7560 [TOLL FREE]  
[www.shopeconcrete.com](http://www.shopeconcrete.com)