



Catch Basins

Type 1

Reinforcing

- ASTM / WSDOT requirements
- All components
- #3 grade 60 reinforcing

Riser Weights

- 2-inch / 100 lbs
- 4-inch / 200 lbs
- 6-inch / 300 lbs
- 12-inch / 600 lbs
- 24-inch / 1200 lbs

Precast Base

- Base unit has four-way knock outs provided for pipe entry
- 2150 lbs

Conformity Standards

- Washington State APWA / WSDOT Standard Specifications
- WSDOT B-5.20.-03

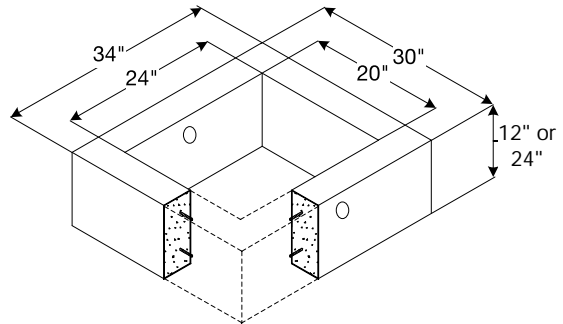
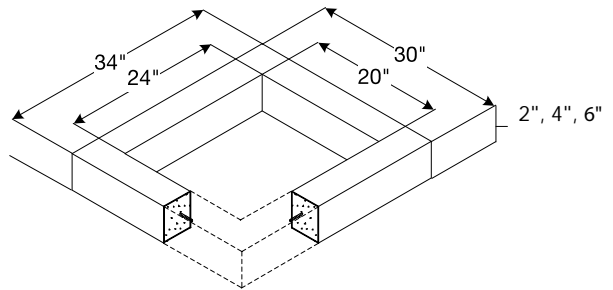
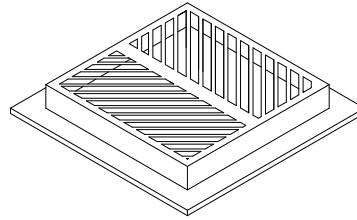

Type I Profile View

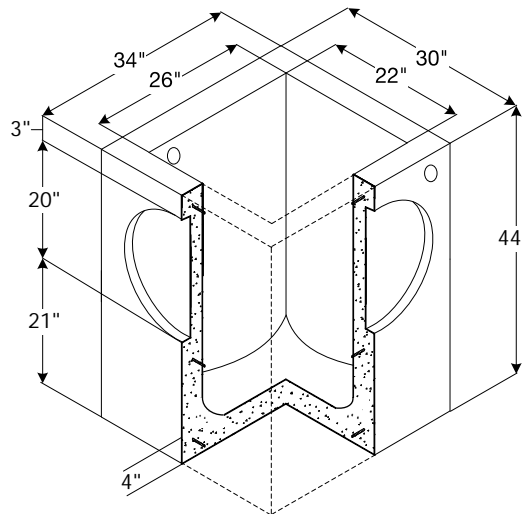
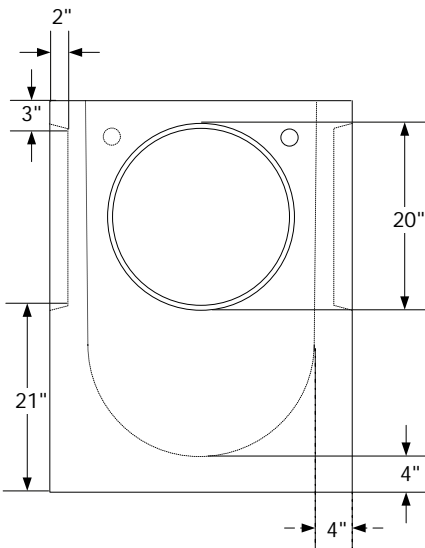

Note: Drawings not to scale

www.shopeconcrete.com

1-800-422-7560 [TOLL FREE]



Shope Concrete, LLC
1618 East Main Avenue
Puyallup, WA 98372-3142

(253) 848-1551
Fax Line 1 (253) 845-0292
Fax Line 2 (253) 864-6172

